



All Hallows Herald

All Hallows Guild—Stewards to the Gardens and Grounds of

Washington National Cathedral

Volume XXVIII, Issue I

Spring, 2005—Flower Mart Edition

Switzerland's Gift to Flower Mart 2005

By Peggy Pickard

**FLOWER
MART**

WASHINGTON NATIONAL CATHEDRAL
WISCONSIN & MASS. AVENUES, NW
SPONSORED BY ALL HALLOWS GUILD

FRIDAY, MAY 6, 2005
10 AM TO 6 PM
SATURDAY, MAY 7
10 AM TO 5 PM

*Honoring
Switzerland*

**FUN FOR THE WHOLE FAMILY
FREE ADMISSION**

Come Rain or Shine



Flower Mart Chair, Susan Foster and Susanne Blickenstorfer

One of the pleasures of creating the annual Flower Mart is the partnership of honored countries with the many talented volunteers who lend their expertise to the event. Never daunted by distance or language, diverse groups gather to produce one of the most entertaining family festivals in Washington.

For this, our 66th Flower Mart, **May 6 and May 7**, we are honored to welcome Susanne Blickenstorfer, wife of the Ambassador of Switzerland to the United States, His Excellency, Christian Blickenstorfer. As busy as she is with her duties in Washington, Susanne

Blickenstorfer has already entertained the Flower Mart Committees at a Morning Coffee at the embassy, where guests became acquainted with some of the plans. (See photo on the next page.) Flower Mart chair Susan Foster introduced Mrs. Blickenstorfer to the committee chairs and they in turn were charmed and grateful for her warm interest. She expressed her thoughts with these words: "I'm proud that Switzerland will be this year's guest of honor at the Flower Mart. Flowers play an important part in Swiss culture. They reflect the passion of the Swiss for nature and their commitment to protect the environment." Mrs. B's background is fascinat-

Continued on Page Two

Switzerland's Gift to Flower Mart 2005 (continued)

ing. Educated at Zurich University where she studied language and business administration, she moved on to serve as section Head in the Swiss Federal Office for Foreign Economic Affairs. After her marriage in 1980, she traveled with her husband to posts in Thailand, Iran and Saudi Arabia. From 1989 to 1993 they lived here in Washington, D.C. while he served as Deputy Chief of Mission. They have two children, Martin, age 22, and Sarah, age 20.

Among her various interests are music and art. An accomplished horsewoman, she has always enjoyed riding, as well as reading and travel. Active in the cultural life of Washington, she has also participated in conferences and discussions on political and international affairs. And, of course, there are → gardens and the flowers she has enjoyed in

all the countries in which the Blickenstorfers have lived. Her very favorite flower is the exotic orchid. As she says, "It is delicate and full of life, and with care, it will bloom again." In the Ambassador's residence, Mrs. Blickenstorfer chooses the colors and designs carefully, blending them for season and occasion. The beautiful flowers of Switzerland are the Edelweiss, Geranium and Enzianum which flourish in that country. But here, Susanne Blickenstorfer has found, in her words, "the greenest Capital city" she has ever lived in and that speaks well for the Flower Mart, where green lawns and carpets of flowers always steal the show.



Edelweiss



The treats were delicious at the Swiss Embassy Coffee.....



.....and everyone who attended enjoyed it all immensely. All Photos courtesy of Rolf Frei



Looking for a bit of Switzerland in our Bishop's Garden?

Board Member, Suzanne Miller remembers seeing Campanula Carpatica or 'Blue Chips' growing in the cracks of a Swiss castle's wall. You can find this sweet blue flower in the Bishop's Garden's lower perennial border, or "blue border", in the spring. See it early; by mid-summer the Washington heat and humidity tend to "melt" it out. Suzanne has contributed an article in this newsletter on the monastery at St. Gall and its influence on the Bishop's Garden, found on page 3



L to r: Kay Diane Bowles; Susan Foster (Flower Mart '05 Chair); and Dede Petri (President, AHG)

The Hortulus with Thanks to Switzerland

By Suzanne Miller

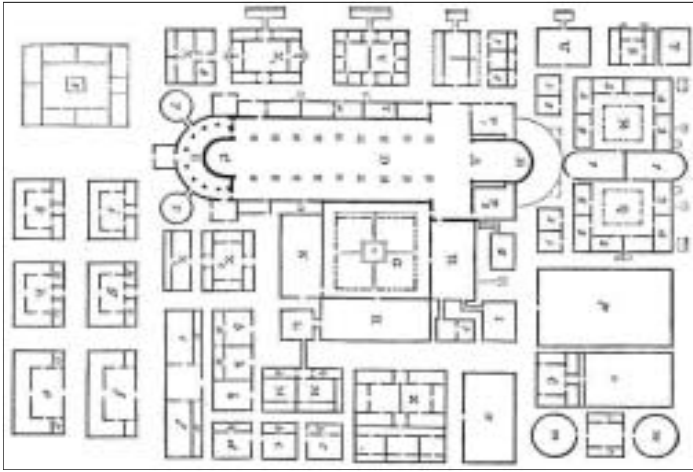

A small herb garden in the Washington National Cathedral's Bishop's Garden, owes much to an ancient manuscript shelved in a monastery library in Switzerland. The parchment depicts the garden and buildings for a Benedictine monastery as it might ideally be built in 820 A.D. Today the plan of St. Gall is kept in the Library of the St. Gall Monastery near Lake Constance where it has been conserved for 1200 years. It is a Swiss National Treasure.

The Plan depicts the buildings and gardens for a community of 270 in a complex and highly detailed way. The Cathedral and buildings were designed to house an almost self-sufficient community including a large cloister, paradise gardens at either end of the Cathedral, a medicinal garden, a vegetable garden and an orchard cemetery. The Infirmary Garden has 16 medicinal plants. The vegetable garden is divided into 18 plots of seasoning and spice plants. The Orchard Cemetery has fourteen different fruit trees. Plant names have been written on each of the beds.

The Cathedral Gardens' greatest benefactor, Mrs. George Bratenahl, recognized immediately that the 1926 Olmsted plan for a tiny herb garden in the midst of the extensive garden being laid out to the south of the Bishop's house lacked only a commanding central feature. On one of her visits to George Grey Barnard's collection she found a large stone font dating from Carolingian times amongst the treasures Barnard had

collected in Europe (the basis of the Cloisters Collection at the Metropolitan Museum). It was this Carolingian font which she purchased and had set in the center of the Hortulus in the midst of the Bishop's House garden.

At Mr. Olmsted's urging, Mrs. Bratenahl choose the plants for the herb garden surrounding the font. She knew of a poem describing a 9th century medieval herb garden, Hortulus by the monk Walahfrid Strabo. Strabo tells of cultivating and using over twenty different herbs in his own herb garden. He, too, is one of our Swiss connections. He was an abbot of the monastery at Reichenau, not far from Lake Constance.



**The Cathedral Church
at the
Convent of St. Gall**

Both the Plan of St. Gall and Hortulus mention rose, iris, lily, rosemary, costmary, nigella, fennel, lovage, mint and sage. These are the fragrant flowery herbs that grow in the Hortulus Garden at Washington National Cathedral today, far away in time and place from the 9th century monks but a living remembrance of what we and they love in the garden.



The Hortulus—Bishop's Garden
Photo by Lynn Horner Keith

The Herb Cottage Announces “First Thursdays” By Peggy Pickard

Beginning April 7, the Herb Cottage Gift Shop is launching a new shopping calendar with the introduction of “First Thursdays”, a one-day-a-month event featuring longer hours, new merchandise and hospitality galore. Refreshments, gift wrapping and helpful personal service from 10 am to 6:30 pm will highlight the longer shopping hours and easier parking.

Amid the festival of colorful gifts and foods, customers will find a rainbow of contemporary vases, linens and china. All the old favorites, the fragrances and soaps, the heritage china designs and herb delicacies—will be available. →



Is your Group Planning to Visit the Cathedral?

The Herb Cottage
is a charming gift shop featuring special & unique gifts located next to the Bishop's Garden. Refreshments and discounts will be offered—just call!
202-537-8982

Operated by All Hallows Guild
Open every day from 10 am to 5 pm and the first Thursday of the Month until 6:30 pm
Come See our new Spring Inventory
Ample Summer Parking

Gardeners will find the famous Atlas Gloves for hand protection and practical multiple-tool garden sets. Vera Bradley bags in various shapes, colors and design are always available. Handsome lamps, sparkling tapers from India, elegant picture frames in silver or mirrored designs and the ever-popular line of platters, bowls and dining ware will be offered.

“First Thursdays” promise to be a bonanza for shoppers looking for home and garden gifts in the charming atmosphere of the century-old Herb Cottage, where history mingles with twenty-first century life.

Remembering Nanie Anderson By Linda Daisley

It is with great sadness we report that Eugenie Ward Riley Anderson passed away on February 9, 2005. She was the beloved wife of the late Col. Joseph C. Anderson and devoted mother of Judith, Alanson, Adelaide, Eugenie, Joseph and the late David Anderson.

Eugenie (or “Nanie”) was a Cathedral volunteer since 1961, a member of the Cathedral Flower Guild, an active All Hallows Guild Board member since 1985, and a Life Member of the Guild.

Nanie will be long remembered for her many years of work on Flower Mart, her charming and lively wit and her passion for flowers. She was an early member of the Sumner Garden Club and in that capacity she wrote to the Treasurer of the Club just two weeks before she died, when she thought

→



Nanie addressing the June 2003 AHG Board Meeting at the Cathedral College, Washington National Cathedral

her dues were not current. Quoting from that note, her love of flowers, even the lowly dandelion, is so evident:

“I hope you love the dandelion as I do. You don’t have to plant it or fertilize it or spend any time on it. Up from its lacy green skirt shoots the tall, silky stem to hold the lovely green velvety disk that is its flower. It is the delight of children with which they play games and make wonderful things—earrings and curls, bracelets and necklaces—and no grown-ups ever tell them not to pick the flowers.”

Memorial contributions in Nanie’s name, may be made to All Hallows Guild by using the form on the back of this newsletter.

Important Dates

April 1—October 31 **Docent-guided Tours** of the Bishop's Garden are offered. Unreserved tours meet at the Herb Cottage on Wednesdays at 10:30 am. For Group Tours & Reservations, call: 301-986-1290.

Woods Walks

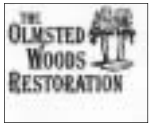

Thursdays, April 7, 14, 21 & 28 at 10 am. "The Greening of the Olmsted Woods." Join wildflower and horticultural experts for this series of walks designed to track the "greening" of the Woods during the month of April.

Thursday, May 5 at 8:30 am—Birdwalk with Sheila Cochran. Don't forget your binoculars and sturdy shoes.

Friday & Saturday, May 6 & 7 at 2 pm—Flower Mart. Want a break from the excitement? Take a relaxing tour in the Woods and learn more about the Restoration Project. Tour leaders, Dede Petri and Anne Elsbree.

Thursday, May 12 at 10 am— "Conserving Your Water—Rain Gardens & Other Solutions" Joe Luebke, Cathedral Director of Horticulture is Tour Leader. **A Birdwalk precedes this tour at 8:30 am.**

Thursday, June 16 at 10 am— "Invasive Plants" Tour Leader, Nate Heavers, Cathedral Horticultural Manager.

Thursday, July 21 at 7 pm- "Evening in the Olmsted Woods." Tour Leader: Dede Petri

Unless otherwise noted, Woods Walk participants meet at the George Washington Statue. No reservations required. Free of charge. Questions? Woodlands Phone line: 202-537-2319

Special Tour & Tea

Thursday, July 13 at 1:30 to 4 pm— "Native Plants In the Woods and in Your Garden". Join us as we learn more about the native plants growing in the Olmsted Woods & how you can use them in your garden. Tour Leader, Anne Elsbree. After the tour, tea will be served in the Cathedral Tower. Fee is \$22. Reservations required: **202-537-8993**

Note Date Change

The Cathedral Grounds Provide Valuable Teaching Tools

By Llewellyn Bensfield



The Close was aflutter when the Cathedral grounds became an avian laboratory last May. To highlight a year-long unit on "Birds," **Beauvoir** Director of Outdoor Education, **Anne Rosenbaum**, invited Smithsonian scientists to place a Neighborhood Nestwatch site on the Close. Nestwatch gathers scientific data about the reproductive success of urban and suburban birds and their year-to-year survival. The Close was perfect. While Nestwatch had the use of rare urban woodlands, the second graders had the experience of watching biology in action, right in their own back yard!

Bob Reitsma, a scientist in the Avian Ecology Lab, Smithsonian Environmental Research Center, and Mary Deinlein from the Smithsonian Center for Migratory Birds selected four bird stations around the grounds --- in the Olmsted Woods, in the wooded area hardby the Nietzsche garden, behind Beauvoir and in the Beauvoir courtyard. Early one morning, the scientific team erected mist nets and twenty birds were captured. As children observed, scientists removed the birds, identified, weighed and measured them, guessed their ages, and looked for brood patches on the females. After recording the data, they banded each bird for future observation before releasing it.

"The Cathedral Close has a well-deserved reputation as a beautiful and spiritual place, but few people realize what a valuable teaching resource it is," says Rosenbaum.

"The grounds serve not only as an inspiration for art and poetry, but also as a laboratory where students can spend countless hours studying a wide variety of flora and fauna."

With the approach of spring, many of the banded birds may once again return to breed on the Close, and Rosenbaum's students will be eagerly awaiting.

Note: Anne Rosenbaum is no stranger to the Cathedral. The daughter of Bishop Ted and Sarah Eastman and an NCS graduate, she has taught environmental science at Beauvoir for two years.

The “Tales of Tea” - A Thank You Tea for Volunteers—So Much Fun!



Fire-engine red was the color of the day, January 26th, when the multi-talented Betty Gordon again hosted our Tour and Tea Program volunteers at a “Thank You Tea”. Betty’s “Calendar Girls” (our volunteers) adorned the walls of the Tea Room—much to the delight of everyone. It was also a time to say “so long” and thank you to long-time Tea Captain, Dodie Paige (See Dodie at left as Betty Gordon’s version of a red-hatted Calendar Girl) and Tea Reservations Coordinator, Louise Lynn,

both of whom have moved from the Washington area. Our goodbyes did not dampen the fun, though, as our guests sipped tea and enjoyed Donna’s delicious tea savories created just for them.



Do You Have a Donation For the Flower Mart White Elephant Sale?

We welcome donations of:

- Unusual pieces of china or pottery
- Linens in excellent condition
 - Boutique gifts
 - Costume & fine jewelry
 - Collectibles
- Decorative items for the home and garden

Call Mary Lou Semans for pickup arrangements and donation tax forms at: 301-320-4095, between 10 am and 4 pm.

Visit the White Elephant Sale in Guild Hall May 6 & 7 to see these re-cycled treasures

Tour & Tea Facts

- Approximately 48,000 guests have been served tea since the program began.
- Donna Allanson has been catering the Tour & Tea Program since it began in 1990. If you would like Donna to cater your tea or party, call her: 1-540-635-0517
- The *secret ingredient* in the shortbread cookies is cayenne pepper.
- It takes about 75 dedicated volunteers to run this program all year long.
- Tour & Tea is offered every Tuesday & Wednesday afternoon. It is \$22.00 per person and requires a reservation. Call Kate Hundley at: 202-537-8993.
- Reservations will soon be taken on line





Save the Date!!

**Friday, April 29, 2005
7 - 10 p.m.**

Gala on the North Lawn!

You won't want to miss this very special evening featuring our Flower Mart host country Switzerland!

Swiss food, Swiss dance and celebration.
\$100. per person

All proceeds benefit the gardens and grounds of Washington National Cathedral.

To be sure you are on our guest list, call 202-537-2937



AHG to Offer Florence Bratenahl Scarf

In 2006, All Hallows Guild will celebrate its 90th anniversary! In tribute to our indomitable founder, Florence Brown Bratenahl, we are pleased to be offering a Limited Edition scarf at this year's Flower Mart gala, featuring the botanical drawings of none other than Mrs. Bratenahl on a periwinkle blue background. The 36 inch square scarf is being fabricated by famed French silk manufacturer, Cedric Brochier Soierie. Those attending the gala may purchase the scarf for \$85. Thereafter, it will retail for \$100.00 in the Herb Cottage.



All proceeds benefit the gardens and grounds. Don't miss out on this very special offer.



Thank you, Bishop Chane, for conducting the beautiful service—blessing the Herb Cottage commemorating its 100th birthday, November 1, 2004.

VOLUNTEER DOCENTS NEEDED

Garden and Olmsted Woods Tours

SPONSORED BY ALL HALLOWS GUILD
WASHINGTON NATIONAL CATHEDRAL



Garden Docent Training: Last Saturday, March through September at 10 a.m., garden walk-arounds, history and horticultural reading. Docents lead tours Wednesdays at 10:30 a.m. and for groups by reservation. Information: 301.986.1290

Olmsted Woods Docent Training: Two training sessions, attend Walks, background reading and native plant studies. Walks are offered once a month on Thursdays at 10 a.m., weekly during April and May. Information: 301.530.9191



ALL HALLOWS HERALD

All Hallows Guild
Washington National Cathedral
Wisconsin and Mass. Aves., NW
Washington, DC 20016-5098
All Hallows Guild Office: 202-537-2937

Visit us on line: Allhallowsguild.com

The All Hallows Herald is published three times a year and is sent to paid-up Guild members at no charge. Contributing writers: Llewellyn Bensfield, Linda Daisley, Suzanne Miller, Dede Petri, and Peggy Pickard. Editor: Linda Daisley

NON PROFIT ORG;
U.S. POSTAGE PAID
PERMIT NO.#1
SUBURBAN, MD
20898

RETURN SERVICE REQUESTED

OLMSTED WOODS RESTORATION Progress Update

- During **Phase I**, extensive analysis was done of the five-acre Olmsted Woods. Exotic invasives were eliminated, followed by extensive planting of native plants and trees.
- The Pilgrim Way, which winds through the Woods to the George Washington Statue at Pilgrim Road, was built. **Phase II**, included construction of cutting-edge water management techniques for the ravine and the steep slopes of the Woods. Planting of native plants and trees continued. The Woodland Bridge was rehabilitated.
- **In Phase III**, cost of the amphitheater revitalization will be approximately \$750,000. **\$350,000** has already been raised by the Guild for this final phase.

Contact Dede Petri, 202-298-8109, for more information on how you can be a part of this exciting Project.

ALL HALLOWS GUILD ACTIVITIES

- ▶ Garden tours are conducted by All Hallows Guild docents April through October. An unreserved tour leaves from the Herb Cottage each Wednesday at 10:30 am. Reserved tours are available by calling (301) 988-1290.
- ▶ Woods walks take place throughout the year, and seasonal bird walks when appropriate. Olmsted Woods infoline: (202) 537-2319.
- ▶ The Guild raises funds in a variety of ways: Flower Mart, held the first Friday and Saturday of May each year; the Herb Cottage, a gift shop open 10 am to 5 pm daily; Tour and Tea, which is co-sponsored with Visitor Programs and combines a tour of the Cathedral with an elegant tea; and gifts and memorials.

For more information about all All Hallows Guild, call (202) 537-2937. Memorial opportunities are available in the Gardens and Woods. Call Louise Beale (301) 951-3913.

By joining All Hallows Guild or making a donation you directly support the care and beautification of the gardens, grounds, and woodlands of Washington National Cathedral.

MEMBERSHIP

I would like to join All Hallows Guild:

- Annual \$20 Benefactor \$50
 Steward \$100 Life \$500 (Endowment)

GIFTS AND MEMORIALS

I would like to give my gift of \$_____ for:

- Gardens/Grounds Memorial Bench \$3,500
 Woods Restoration Tree \$1,000

NAME _____

ADDRESS _____

CITY/STATE/ZIP _____

FOR GIFTS AND MEMORIALS

Please send notification of this gift/memorial to:

NAME _____

ADDRESS _____

CITY/STATE/ZIP _____

IN HONOR OF _____

Please charge (total) \$_____ to my:

- Visa MasterCard

ACCOUNT # _____

EXPIR DATE _____

CARDHOLDER'S SIGNATURE (Required for all credit card transactions)

Part of each donation is reserved for the care of the grounds. Please make your check payable to All Hallows Guild, Washington National Cathedral, Massachusetts and Wisconsin Avenues, NW, Washington, DC 20016-5098.